



Norden Mfg LLC  
 4210 Kinsman Rd NW  
 North Bloomfield, OH 44450  
 877-296-5851 - www.nordenmfg.com

# Squeeze Arm Installation Instructions

- #1017330 Upgrade Squeeze Kit, 408F
- #1017340 Upgrade Squeeze Kit, 510
- #1017350 Upgrade Squeeze Kit, 510F
- #1017360 Upgrade Squeeze Kit, 612F, 615
- #1017370 Upgrade Squeeze Kit, 615L
- #1017380 Upgrade Squeeze Kit, 615F, 618
- #1017390 Upgrade Squeeze Kit, 618L

- Refer to "Parts: Step 1-5" on page 5 -

1. Remove crowd bar from right hand side of grabber. You will be reusing the longer of the two bolts.  
 Install Side Plate on left side using provided 3/8" x 2.75" hex bolts and nuts.

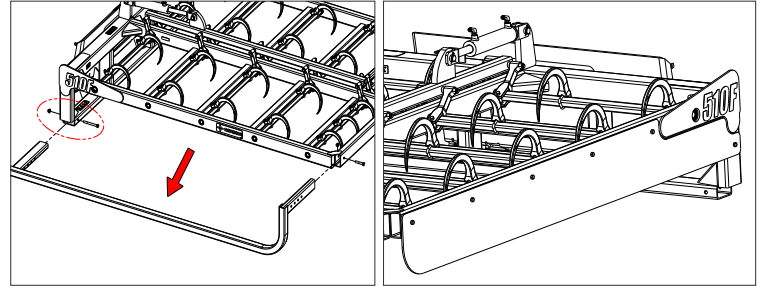

**NOTE:** The directions left, right, front, and rear, as mentioned throughout this guide, are as seen from the direction of travel.

2. Weld the Squeeze Bar Cylinder Mount onto the correct 2x2 crossbar as shown.

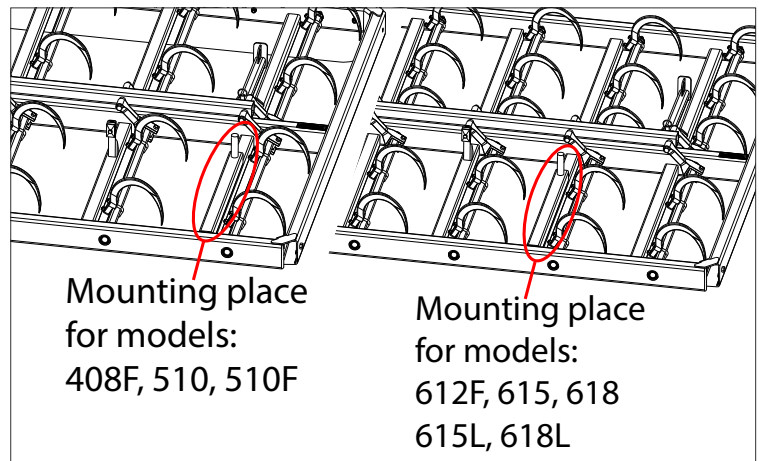

3. Weld the Squeeze Arm Guide Tab onto the frame of the Grabber offset of the Cylinder Mount position as shown. This must be offset to allow proper movement of the Squeeze Arm.

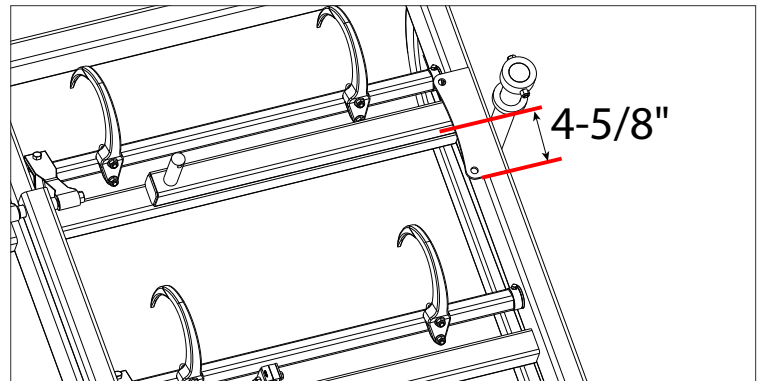

4. Weld the Sequence Valve Mount onto the top of the rear 4x4 frame with dimensions shown.

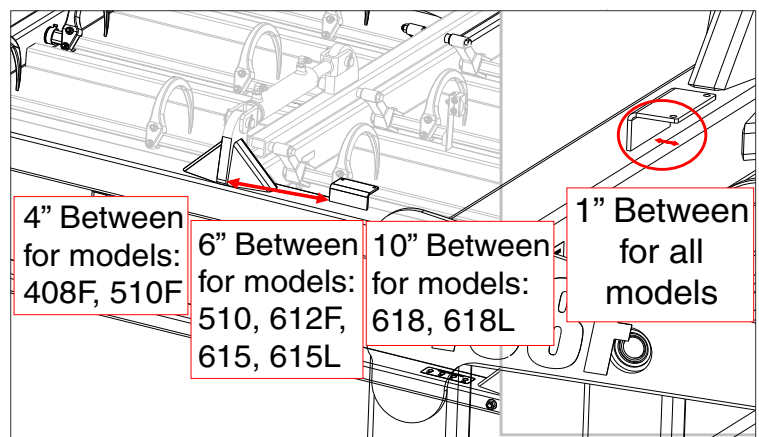

5. Weld the Hose Clamp Risers, on 2x2 crossbar roughly halfway between the rear of the grabber and the cylinder. Ensure hoses will not interfere with hook movement.
6. Prime and paint parts to prevent rust.

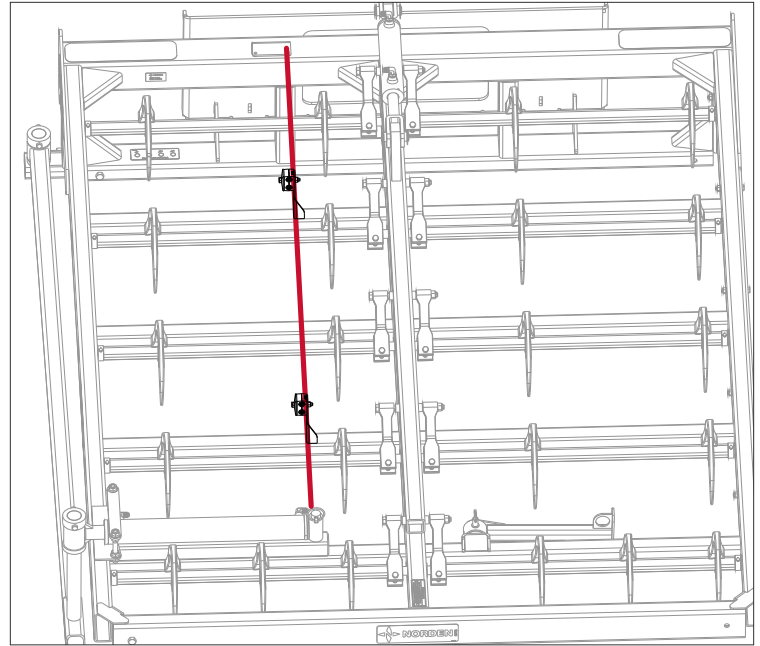

- Refer to “Parts: Step 7-8” on page 5 -

7. Slide Squeeze Arm Rear Bracket into same slot where the regular crowd bar had been in.
8. Slip the Squeeze Arm onto the pin of the Squeeze Arm Rear bracket. Bolt on the Collar with provided 3/8” x 3” Hex Bolt and Nylock Nut. Grease the Zerk.



- Refer to “Parts: Step 9-10” on page 5 -

9. Replace plugs in Cylinder with provided 90° adapters. Mount the cylinder onto the Cylinder Mount and Squeeze Arm. Use provided Lynch Pin to secure the rear of the cylinder and the Collar with provided 3/8” x 3” Hex Bolt and Nylock Nut to secure the Cylinder onto the Squeeze Arm. Grease both Zerks.

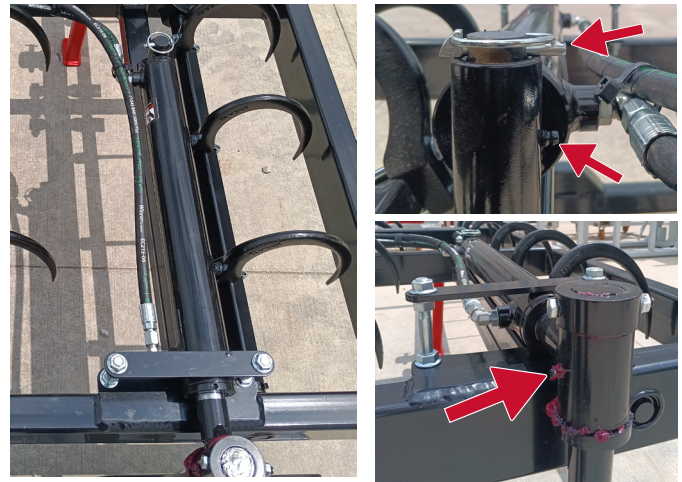

10. Use the provided (2) Cylinder Strap Bolts and (8) 1/2” Flange Nuts to bolt the Squeeze Arm Guide Plate over the Cylinder.

NOTE: Make sure to leave 1/16” space between the Squeeze Arm Guide Plate and Cylinder to allow movement.



- Refer to "Parts: Step 11-14" on page 5 -

11. Mount Sequence Valve Block with provided bolts, washers, and nuts.

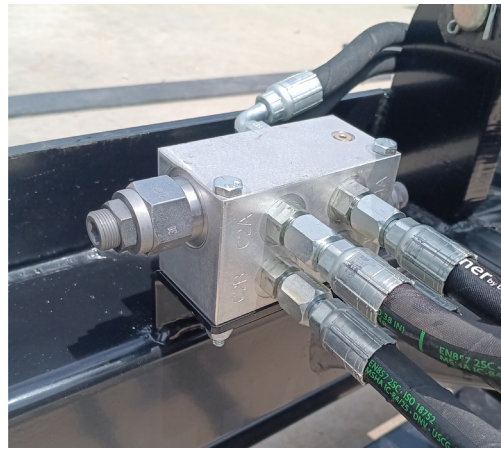

12. Connect hoses according to diagram on the right.

13. On the back of the block, connect male ended skid steer hose to VA and female ended skid steer hose to VB.

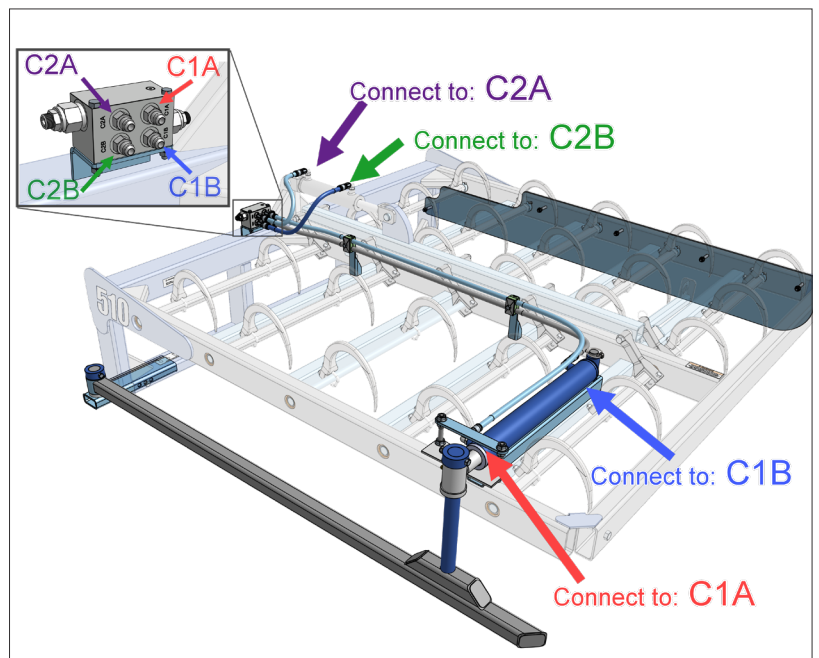

14. Install Hose clamps as shown.

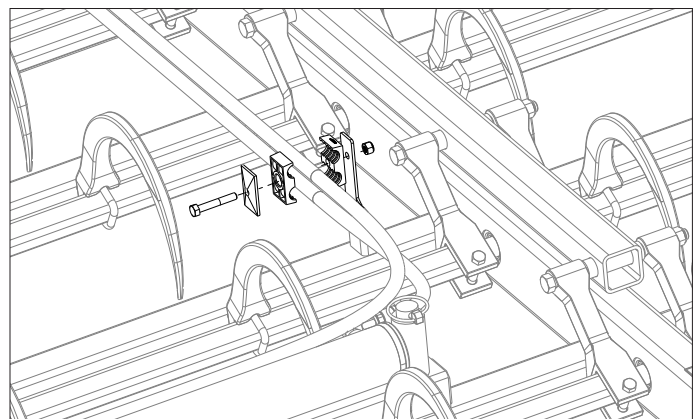

Valve Part Number	Valve Name	Valve Function	Port ID
1009010	SEQUENCE VALVE, PSVP-10	Adjusts when hooks start to grab bales, after the squeeze arm is in	RIGHT SIDE (top one)
1009680	6MJ-6MB STRAIGHT ADAPTER	Causes Hooks to grab bales	C2A
1009680	6MJ-6MB STRAIGHT ADAPTER	Causes Hooks to release bales	C2B
1009010	SEQUENCE VALVE, PSVP-10	Adjusts when squeeze moves after hook release	LEFT SIDE (bottom one)

Valve Part Number	Valve Name	Valve Function	Port ID
1009680	6MJ-6MB STRAIGHT ADAPTER	Causes Squeeze Arm to move in	C1A
1009680	6MJ-6MB STRAIGHT ADAPTER	Causes Squeeze Arm to move out	C1B
1009680	6MJ-6MB STRAIGHT ADAPTER	Hydraulic Oil Input	VA
1009680	6MJ-6MB STRAIGHT ADAPTER	Hydraulic Oil Return	VB



## Parts Detail

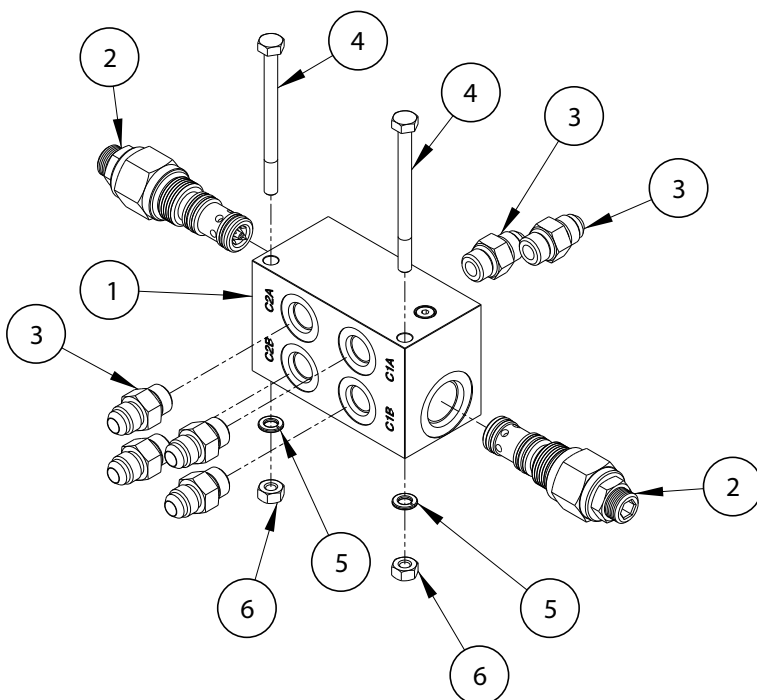

Item	Part Number	Description	Qty
1	1008840	Sequence Valve Manifold	1
2	1009010	Sequence Valve, PSVP-10	2
3	1009680	6MJ-6MB Straight Adapter	6
4	1009740	Hex Bolt 1/4"-20 x 3.25"	2
5	1009730	Spring Lock Washer 1/4"	2
6	1007660	Hex Nut 1/4"	2

## Parts: Step 1-5

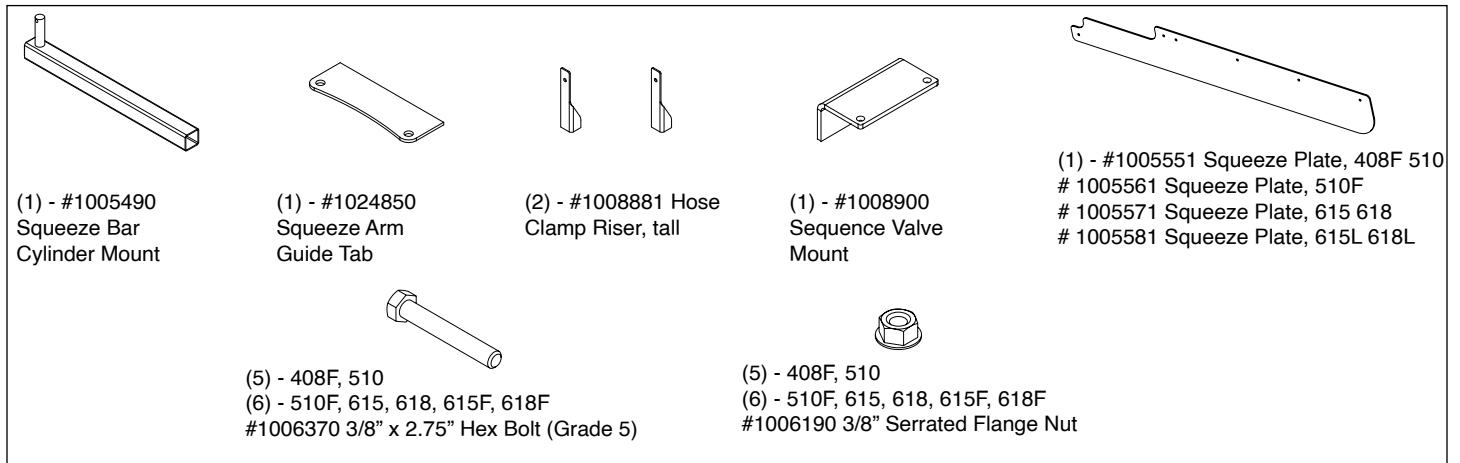

## Parts: Step 7-8

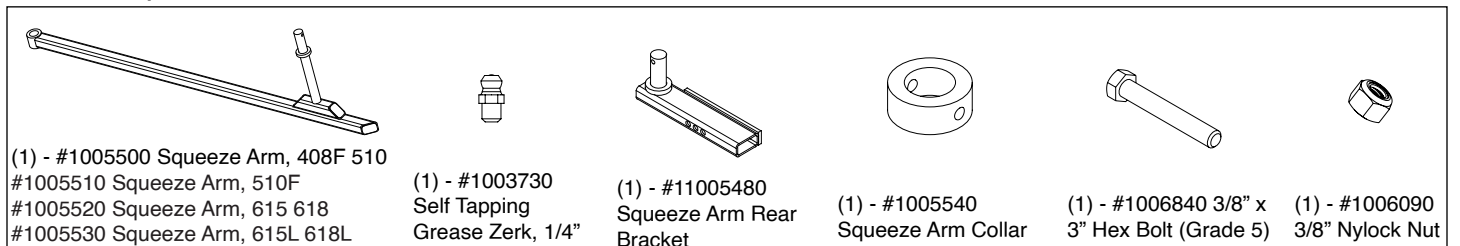

## Parts: Step 9-10

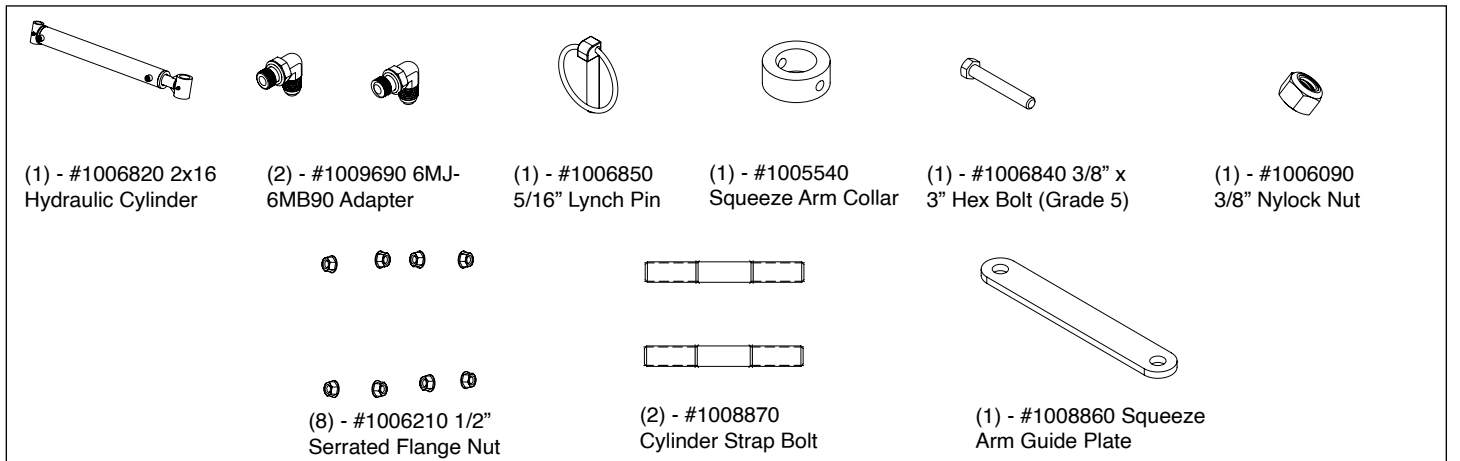

## Parts: Step 11-14

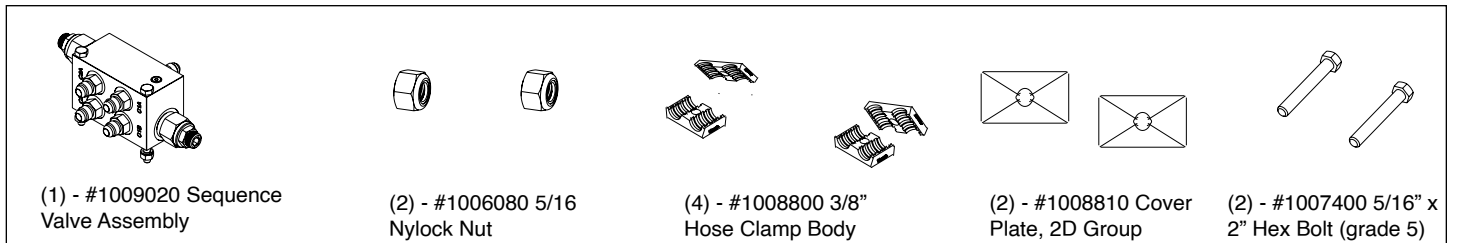

## Parts: Hose Kits

Hose Kit	408F	510	510F	612F-615	615L	615F- 618	618L
Hose from Loader to Port VA	78"	78"	78"	78"	78"	78"	78"
Hose from Loader to Port VB	78"	78"	78"	78"	78"	78"	78"
Hose from Squeeze Cylinder to Port C1A	78.25"	77.5"	96.75"	85.25"	94.5"	89"	97"
Hose from Squeeze Cylinder to Port C1B	60"	58.5"	78"	66.5"	75"	69.75"	77.5"
Hose from Hooks Cylinder to Port C2A	17.25"	19.5"	17.25"	19.5"	19.5"	23"	23"
Hose from Hooks Cylinder to Port C2B	17.25"	19.5"	17.25"	19.5"	19.5"	23"	23"